

### CLASS A-SURFACE

- ❖ CAS (Computer Aided Styling) with Class A-Surface Design in ICEM & CATIA



#### ✓ 3D MODEL - CLASS A



#### ✓ 3D MODEL - ZEBRA



### CAD DATA PROCESSING

- ❖ Participated in design for Honda, Nissan, Suzuki, Mazda.

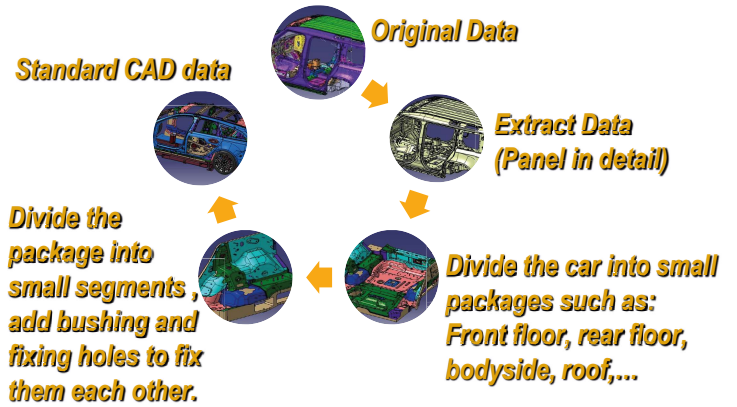

### JIG DESIGN

- ✓ JIG for checking the welding.



- ✓ JIG for checking the shape and assembly position after welding.

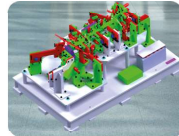

#### ❖ Actual result



- ✓ Other JIG



### LAMP DESIGN

- ❖ Joined in designing Car and Motorcycle lamp.

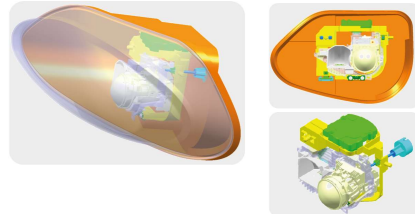

### DESIGN FRONT AND REAR WIPER

- ❖ Previously involved in research and development of Honda, Nisan, Suzuki, Mazda wiper.

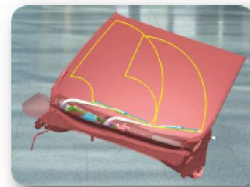

### 3D DESIGN IMPROVEMENT

- ❖ Enhance the shape design according to customer requirements.



### 2D ↔ 3D-CONVERSION

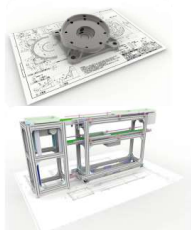

- ✓ Convert 3D models to 2D drawings.
- ✓ Technical drawing 3D representation model.
- ✓ 3D composite/assembly model.
- ✓ Simulation of movement and motion processes.

### REVERSE ENGINEERING

- ❖ High quality surface in reverse engineer (our strength).

- ✓ Physical object → scanned data



- ❖ Parametric Model

- ❖ Hybrid Surface

- ❖ NURBS Surface

### ASSEMBLY LINE DESIGN

▣ Assembly line drawing

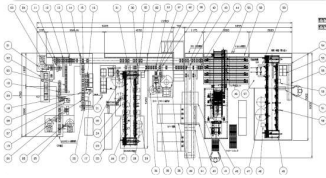

❖ Actual result

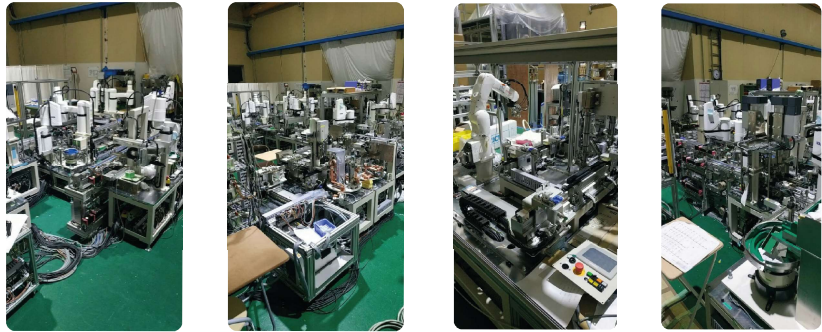

❖ CATIA design data

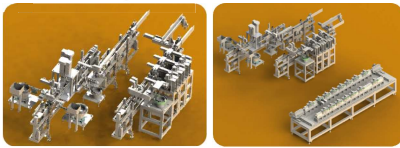

### STATIC STABILITY ANALYSIS

▣ Static stability analysis for the frame will bus



❖ Model

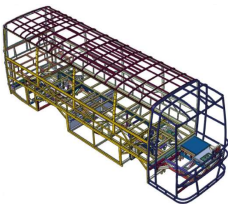

❖ Analysis for strength and displacement

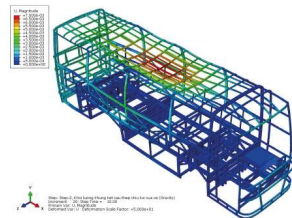

▣ Frequency response analysis

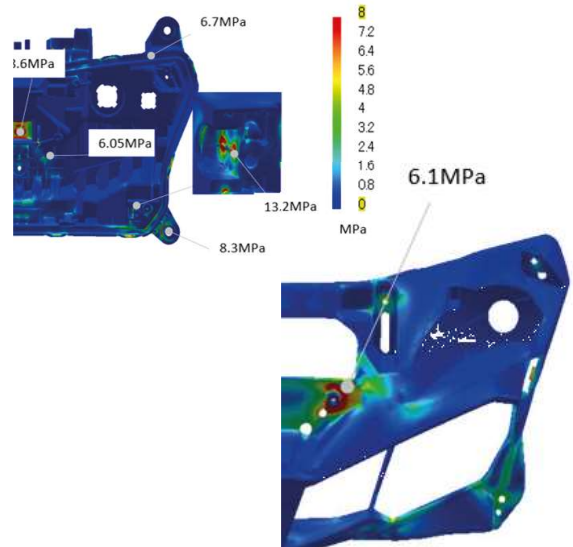

### MACHINING PROGRAMMING

❖ Using VERICUT

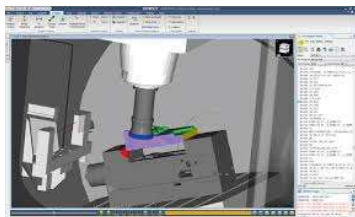

❖ Using CATIA

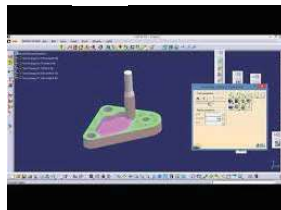

❖ Using Mastercam

